

MICTRON 900-SE FIRE ALARM SYSTEM

MICTRON
SERIES M
MICROPROCESSOR-BASED
FIRE ALARM SYSTEM

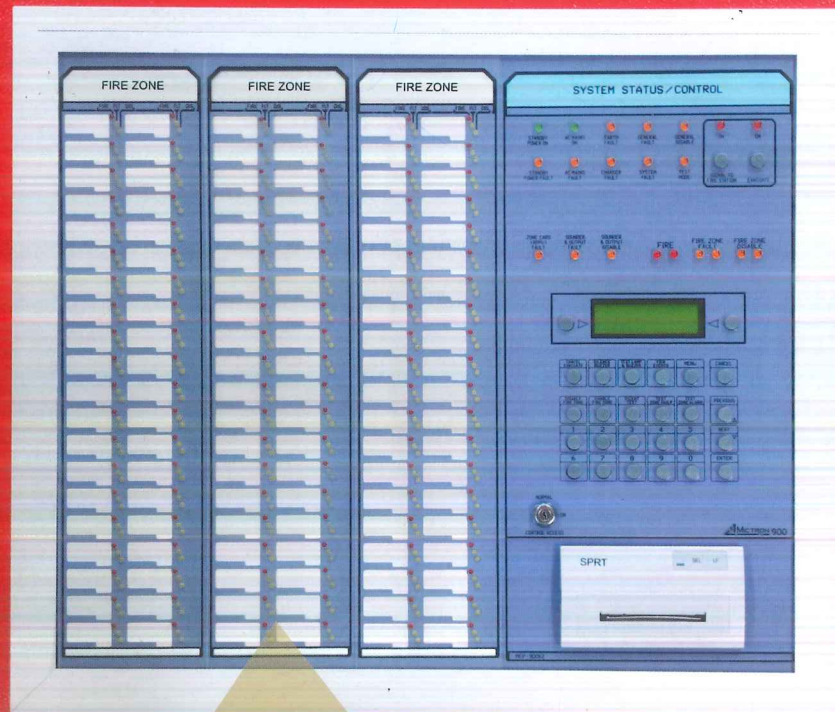

COMPACT DESIGN



UP TO 40 POINTS PER DISPLAY PANEL



CLEAR VISUAL IDENTIFICATION



FLEXIBLE ARRANGEMENTS



CHOICE OF LANGUAGE



MADE IN MALAYSIA

MS1745

EN54

SIRIM QAS

BOMBA APPROVED

MICTRON

RPPU

ADVANCE TECHNOLOGY

PRACTICAL & FLEXIBLE

MICTRON 900-SE MICROPROCESSOR-BASED MULTIPLEX FIRE ALARM SYSTEM

MICTRON 900-SE is a new improved model designed and produced in Malaysia by Micro-CTL Automation Sdn. Bhd. It features state of the art design and meets local requirements.

MICTRON 900-SE CONSISTS OF TWO BASIC PORTIONS

MAIN FIRE ALARM PANEL (MFAP)



The MFAP is the command center of the entire system.

- User friendly system operator keyboard with LCD
- Built-in printer for event logging
- Compact Customized LED Display Panel (DP) for multi-language labelling
- Customize multi-colour Mimic Panel

REMOTE PROGRAMMABLE PROCESSING UNIT (RPPU)



The RPPU is a distributed data gathering panel. All Fire Zone, Status Indications, Control Output, and Bell Zones are connected here. A large capacity of RPPU consists of:

- 32 Inputs (Fire Zones or Status Indications)
- 3 Bell Zone (Expandable to 8)
- 5 Control Outputs (Expandable to 9)

INTERLINKING CAPABILITIES

SPUR INTERLINKING

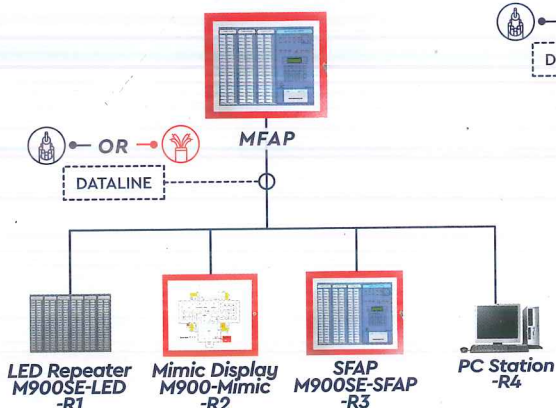

RING INTERLINKING

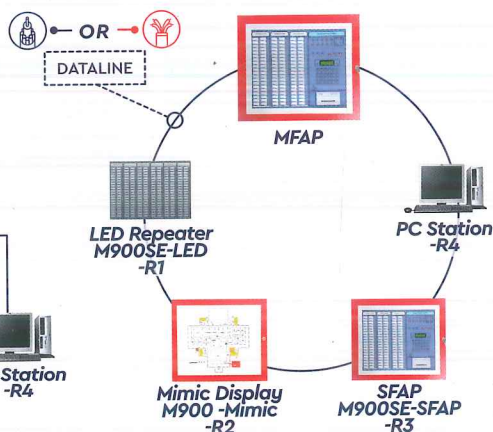

STAR INTERLINKING

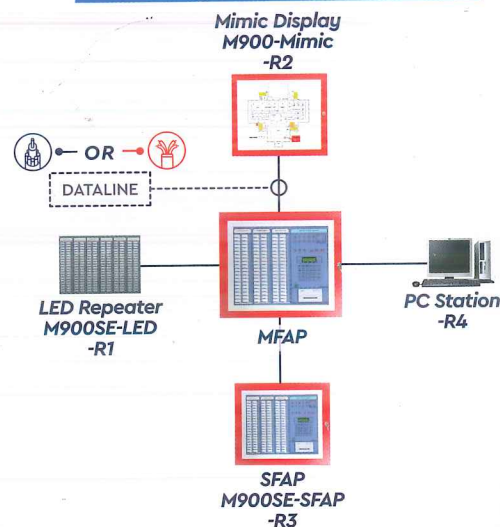

CABLE TYPES



Integration between MFAP and other sub-systems can be achieved by using 2 twisted pair of data cable or other medium. The sub-system can be an active full repeater with simple control function LED display or mimic display with indication only.

High level integration to other building services system can also be achieved through serial communication, with protocol provided. Various converters or modems are available to convert serial communication for optical fiber, Ethernet (TCP/IP) or WIFI communication.

01 3 YEARS SYSTEM WARRANTY

02 10 YEARS PARTS AVAILABILITY

03 AFFORDABLE TOTAL SYSTEM COST

04 FLEXIBLE SYSTEM EXPANSION

05 SIMPLE SYSTEM OPERATION

06 CUSTOMIZED REPEATER DISPLAY OR MIMIC

07 FLEXIBLE OUTPUT CONTROL SEQUENCE

08 MADE FOR MALAYSIA ENVIRONMENT

09 ZONE LED FOR FIRE ZONE, FAULT & DISABLE.

10 COMPATIBLE TO ALL CONVENTIONAL SENSORS

11 BUILT-IN PRINTER

12 AMPLE EX-STOCK SPARE PARTS

13 SERIAL COMMUNICATION OUTPUT

14 PRACTICAL AND COMPACT DESIGN

A TYPICAL MICTRON 900-SE SYSTEM CONFIGURATION

• consists of 2 BUS (or loops) with each BUS linking up to 16 RPPU •

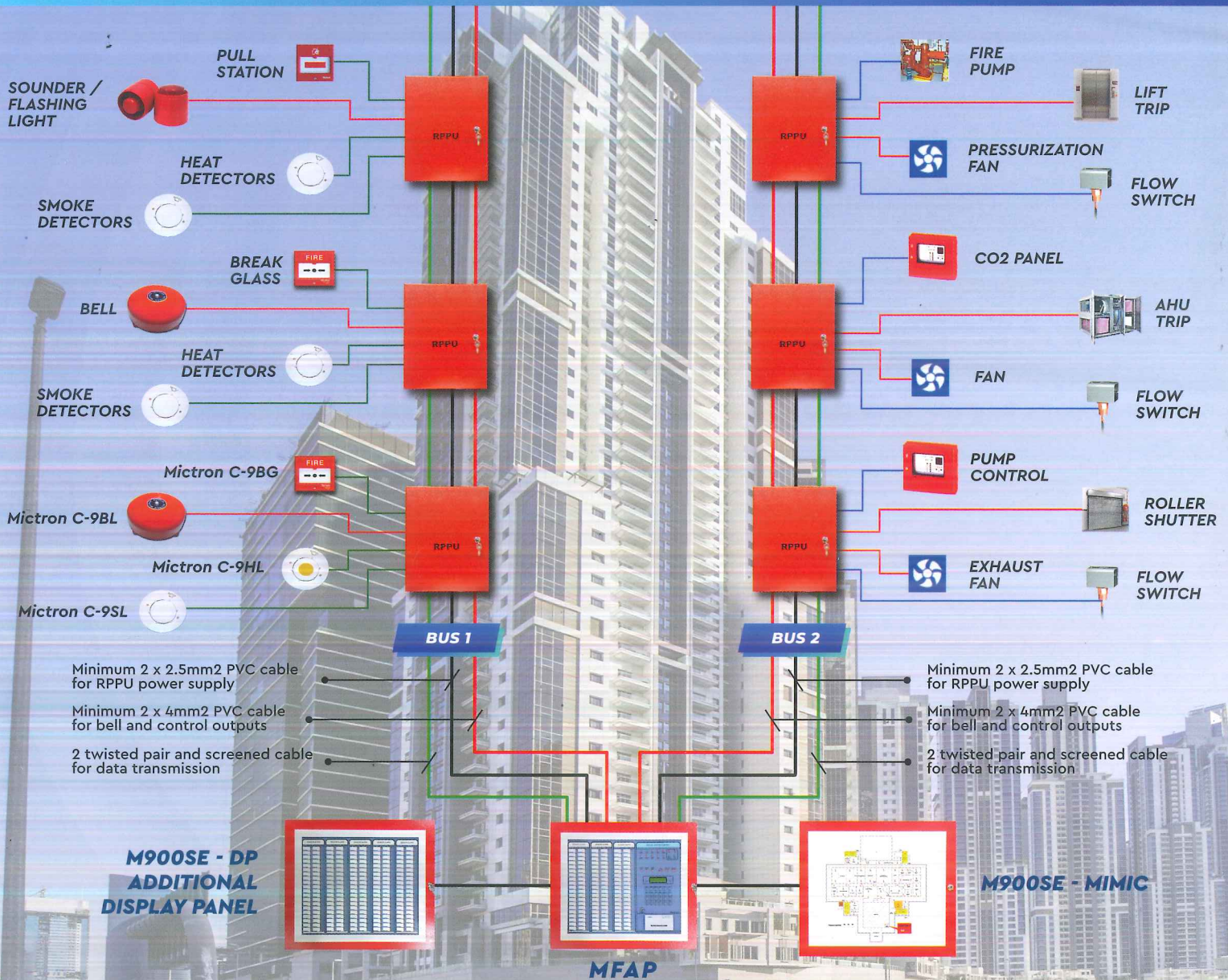

Depending on the distance of the field devices to the RPPU, and the RPPU looping cable to the MFAP, the wire size may vary. Refer to actual project schematic drawing for verification.

TYPICAL INSTALLATION CONFIGURATIONS

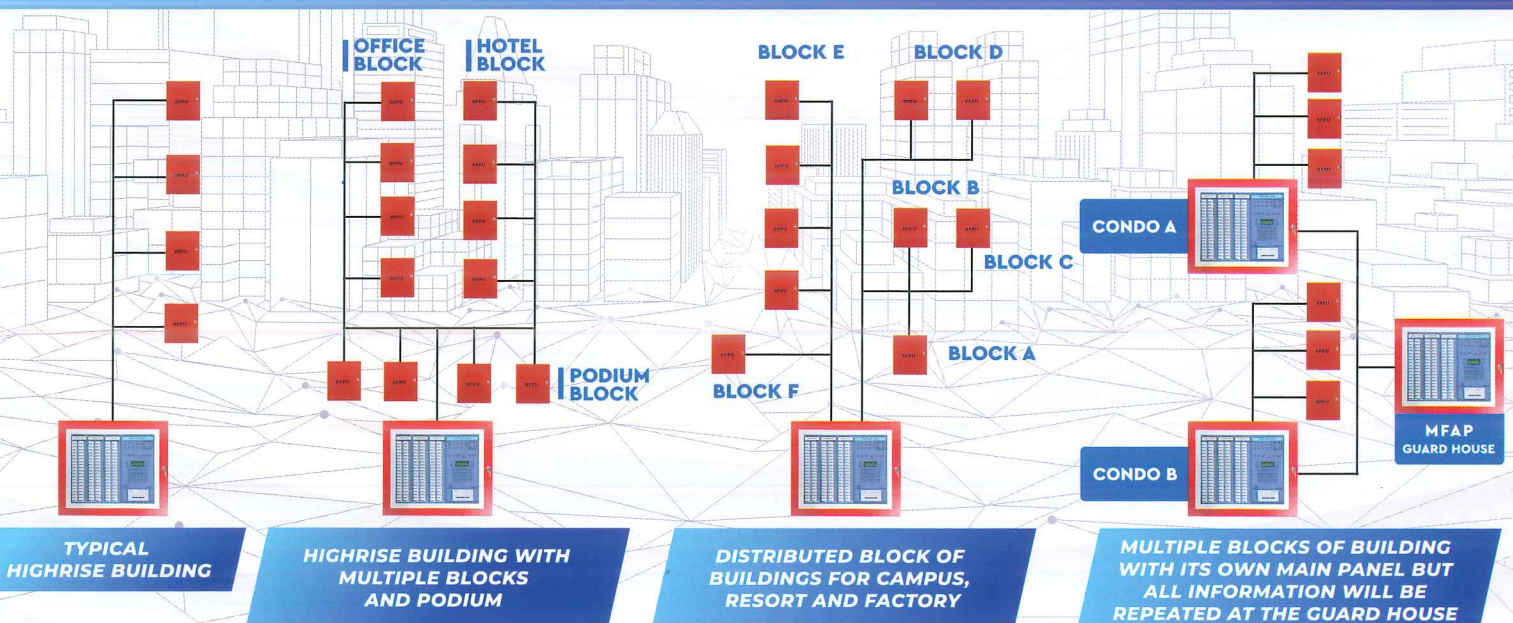

TECHNICAL SPECIFICATIONS

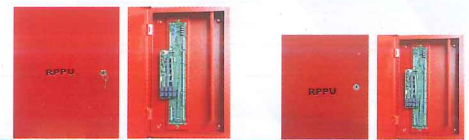

MAIN FIRE ALARM PANEL (MFAP)



Manufacturer	: Micro-CTL Electronics Sdn. Bhd.
Brand	: Mictron
Model	: 900-SE
Microprocessor	: NXP MC9S12
Memory	: 1MB Flash & 64Kb RAM
Ports	: 2 RS232
Fire Brigade Link	: Volt - free contact
Power Consumption	: 24V DC 150mA
Operating Temperature	: 0°C - 45°C
Humidity	: Max 95% (non-condensation)
Panel Construction	: Mild steel/1.6mm thickness
Finishing	: Epoxy powder coated paint
Colour	: Red
Dimension (mm)	: 600 (w) x 530 (H) x 180 (D)
Weight	: 30kg (inclusive of 2 x 12V battery)
Testing Standard	: MS1745 Part2: 2004 : EN 54 Part2: 2004
Test Report	: 2021EB0216
Printer Type	: Impact Dot Matrix
Print width	: 40 characters/line
Printer Interface	: RS232 serial
Manufacturer	: SPRT

REMOTE PROGRAMMABLE PROCESSING UNIT (RPPU)

Model	: RPPU - 32	RPPU - 12
Part Number	: M900-RPPU-ALL (32)	M900-RPPU-ALL (12)
Zone Module Card	: M900-RPPU-CPU	M900-RPPU-CPU
Termination Module Card	: M900-RPPU-TER(32)	M900-RPPU-TER(12)
Capacity Inputs (zone / status)	: 32 or 32 or 27	12
-bell outputs	: 3 3 8	2
-control outputs	: 5 9 4	2
Power Consumption	: 20V -32V DC, 20mA	
Zone Alarm Current	: 10mA	
Operating Temperature	: 0 - 45 degree °C	
Operating Humidity	: 5% - 95% (non-condensation)	
Enclosure Construction	: Mild Steel /1.2mm thickness	
Finishing	: Epoxy powder coated paint	
Colour	: Red as standard	
Dimensions (mm)	: 356 (W) x 548(H) x 128(D)	

POWER SUPPLY & CHARGER FOR RPPU



Model	: MPS-10A	MPS-2A
Part Number	: EXTCHG10A-ALL	EXTCHG1A2-ALL
Maximum Output Current	: 10A	2A
Input AC Voltage	: 220V - 240V AC 50Hz	
Type	: Constant Voltage and Current	
Maximum Output Voltage	: 27.5V DC	
Operating Temperature	: 0 - 45 degree °C	
Operating Humidity	: 5% - 95% (non-condensation)	
Enclosure Construction	: Mild Steel /1.2mm thickness	
Finishing	: Epoxy powder coated paint	
Colour	: Red as standard	
Battery (unknown AH)	: Built in space for 24VDC 7AH sealed lead acid battery (excluded)	
Dimensions (mm)	: 356 (W) x 548(H) x 128(D)	

POWER SUPPLY & CHARGER



Part Number (excl. battery)	: M900-CHG-VIB
Input AC voltage	: 220V-240VAC 50Hz
Type	: Constant Voltage and Current
Maximum Output Voltage	: 27.5VDC
Maximum Output Current	: 7A
Power switches	: AC on, CPU on, RPPU on & Bell on

BATTERY

Manufacturer	: MSB
--------------	-------

DISPLAY PANEL



Part Number	: M900SE - DP
Operating Temperature	: 0°C - 45°C
Humidity	: Max 95% (non-condensation)
Panel Construction	: Perspex sheet on aluminium panel
Panel Colour	: Light grey/blue/black lettering
Enclosure Construction	: Mild steel/1.6mm thickness
Enclosure Finishing	: Epoxy powder coated paint
Colour	: Red
Dimension	: Customized

MIMIC DISPLAY

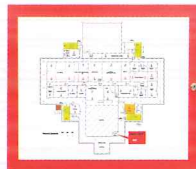

Model	: M900 - Mimic
Material	: Multicolour mimic on perspex with alarm LED
Operating Temperature	: 0°C - 45°C
Humidity	: Max 95% (non-condensation)
Enclosure Construction	: Mild steel /1.6mm thickness
Colour	: Red
Dimension	: Customized



Type	: LED Repeater
Model	: M900-LED-R1
Used For	: LED to show alarm status



Type	: Mimic Repeater
Model	: M900-Mimic-R2
Used For	: Multicolour mimic on perspex with alarm LED



Type	: SFAP
Model	: M900 -SFAP-R3
Used For	: Panel linking to show each other's information



Type	: PC Station
Model	: M900-PC-R4
Used For	: Windows based real time software to show floor plans

Local Control Function	: No <input checked="" type="checkbox"/>	: No <input checked="" type="checkbox"/>	: Yes <input checked="" type="checkbox"/>	: Yes <input checked="" type="checkbox"/>
Power Supply	: 24V DC or external PSU and battery power by 240V AC		: 24V DC or 240V AC (with internal battery)	: 240V AC (with UPS)
Maximum Distance	: 2km	: 2km	: 2km	: 100ft

MICRO-CTL AUTOMATION SDN. BHD. (457153-X)

No.3, Jalan SS13/6A, Subang Jaya Industrial Estate, 47500 Selangor Darul Ehsan, Malaysia.

☎ 006-03 5633 4993 📠 006-03 5636 1117 ✉ sales@micro-ctl.com 🌐 www.micro-ctl.com

Micro-CTL Automation reserves the right to alter specification of its product from time to time without notice.